



*Open Your World*

Veranda

 COUNTRY COACH

THE WORLD'S FINEST MOTORCOACHES





Veranda  
COUNTRY COACH

## *Open Your World*

Adventurers are spurred to embark on each great journey by the passions that drive their heart. The wonder of striking vistas, the company of good friends old and new, the accomplishment of yet another stream crossed and another trail blazed... the passion of an adventurer is grounded in the simplest beauty of nature, tranquility, fellowship, and the promise of the road yet undiscovered.

These adventurers are the heart and soul of Country Coach. For thirty-five

years, this company has dedicated itself to the mission of enabling and uplifting the adventurer's quest. To celebrate the pursuit of another thirty-five years, Country Coach has conceived, engineered, tested and built a better way to discover the beauty in every point on the map, and all the lines in between.

The Country Coach Veranda. Open your world to the evolution of luxury motorcoaching. Today, upgrade your every destination.





## *Upgrade Every Destination*

Thrive on the promise of an unpaved road to who-knows-where. The Country Coach Veranda upgrades the ruggedly beautiful to the ideally-located luxury suite.

Never mind unfriendly terrain. Simply press a button, and 20 seconds later step into the world you've been driving to discover.



A couple, a man and a woman, are standing on the open rear hatch of a motorcoach. They are both smiling and looking out at a sunset over the ocean. The man is wearing a dark jacket and the woman is wearing a light-colored jacket. The motorcoach is orange and has a black metal railing on the hatch. The background shows a calm sea, distant hills, and a warm, golden sky.

## *Live outside the Box*

The world of recreation travel is rooted in the escape from boundaries, the freedom from limitations. Yet, for the history of motorcoaches, people have said goodbye to the sunset when they step inside.

Now, remove the final boundary between you and your dream vistas. Live outside the box, and leave your shoes off while you're at it. The sunset awaits.





## Eat Well, Live Well

The Country Coach Veranda is tailor-fit to upgrade each daily highlight. On select floorplans, easily relocate the dining table to the Veranda deck, and eat out without going

out. A beautiful view, a little wine, a little music, and that inexpressible moment that will remain in your memory forever. Find it in the Country Coach Veranda.



## The Life of the Party

Throw a few steaks on the barbecue. Friends are on the way. Expand your social area with the Veranda, unifying your inside and out into a spectacular multi-tiered party space.

And this party moves. Roll out your invitation at the races, the big game, or the little league game! Anywhere the Veranda is parked is primed for an unforgettable time.





## Fish From Your Own Dock

Let out a little line, while within easy reach of your cool drink. Pick your favorite spot, and bring your home along for the ride. Stable and easily accessible, the Veranda is

more than wheelchair friendly, it also helps you tread lighter. If you so choose, the only footprints to remember you by will be the tire tracks... and a few worn out fish.



## Make Your Plans Come Together

Don't sacrifice relaxing time for some family time. With the Country Coach Veranda, enjoy the outdoors your way while the kids enjoy it their way. Savor the comfort

of your Country Coach motorcoach, keeping an easy eye and ear on playing kids and pets. And enjoy the day together, with a little of everyone's favorite pastimes.



# Engineered Like...Well, Like a Country Coach

The Country Coach Veranda was born of the same steel, the same engineering, the same philosophy for overbuilding that has given us the DynoMax Chassis. The structure and mechanism are inherently solid, well-built, high capacity, and easy to maintain and service.

## Safety • Function • Design

Following the mantra that has been the foundation of Country Coach quality and customer satisfaction for 35 years, the Company's engineers and craftspeople place safety and function as their top priority. The Veranda deck passed substantial weight load and repetition testing, only earning approval when the load held far exceeded the rated capacity, and when the repetition of operation far exceeded the expected lifetime. In addition, the Veranda deck's railing system is built to meet residential code when deployed,



and is designed to provide comfortable and attractive containment of the deck occupants. Multiple fail-safes are designed into the Veranda components to remove some of the potential "oops" factors. For example, when extended, the exterior TV disables Veranda deck operation. Also, when either the Veranda deck is extended, or when the sliding glass doors are not locked, the transmission is disabled automatically. Simply put, the Veranda IS Country Coach. Solid, well built, reliable, and engineered for maximum livability.

# Common Veranda Standards & Options

## Standard:

- Three section sliding arcadia door with screen doors
- Side opening bay doors under the Veranda
- 120-volt receptacle, 12-volt receptacle, speaker jack hook-ups, and exterior Intellitec switch panel
- Power roller day/night shades for sliding glass doors
- Dual layer steel Veranda deck with 3,000 lb. capacity

## Options:

- 37" LCD high definition TV with power Switchblade lift
- LP stainless steel barbecue
- Outdoor folding table and two chairs

## Floorplan-Dependent Veranda Features:

- A/V components located under mid-coach TV
- Dining area moveable table with solid surface top, removable leaf and two chairs
- Galley dual directional countertop rollout with dual directional drawers

# Facts & Figures:

- Patent Pending
- Deck Dimensions: 13'x4'6"
- Load Capacity: 3,000 lbs

- Extension Hardware: HWH drive mechanism (same as used to power Country Coach slide rooms)

- **Time of Operation:**  
*Extension:* less than 20 sec  
*Raise:* less than 30 sec

# Veranda 300 43' RED CLOUD PEAK

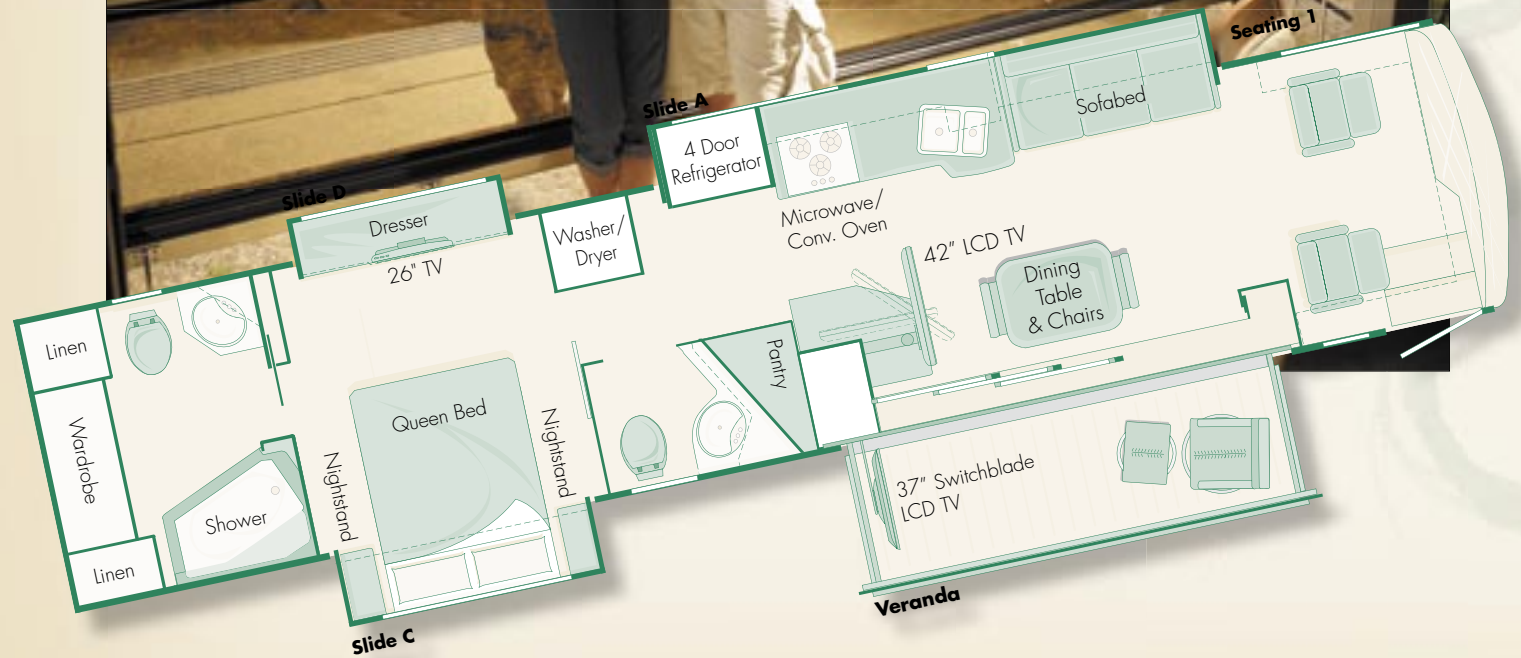
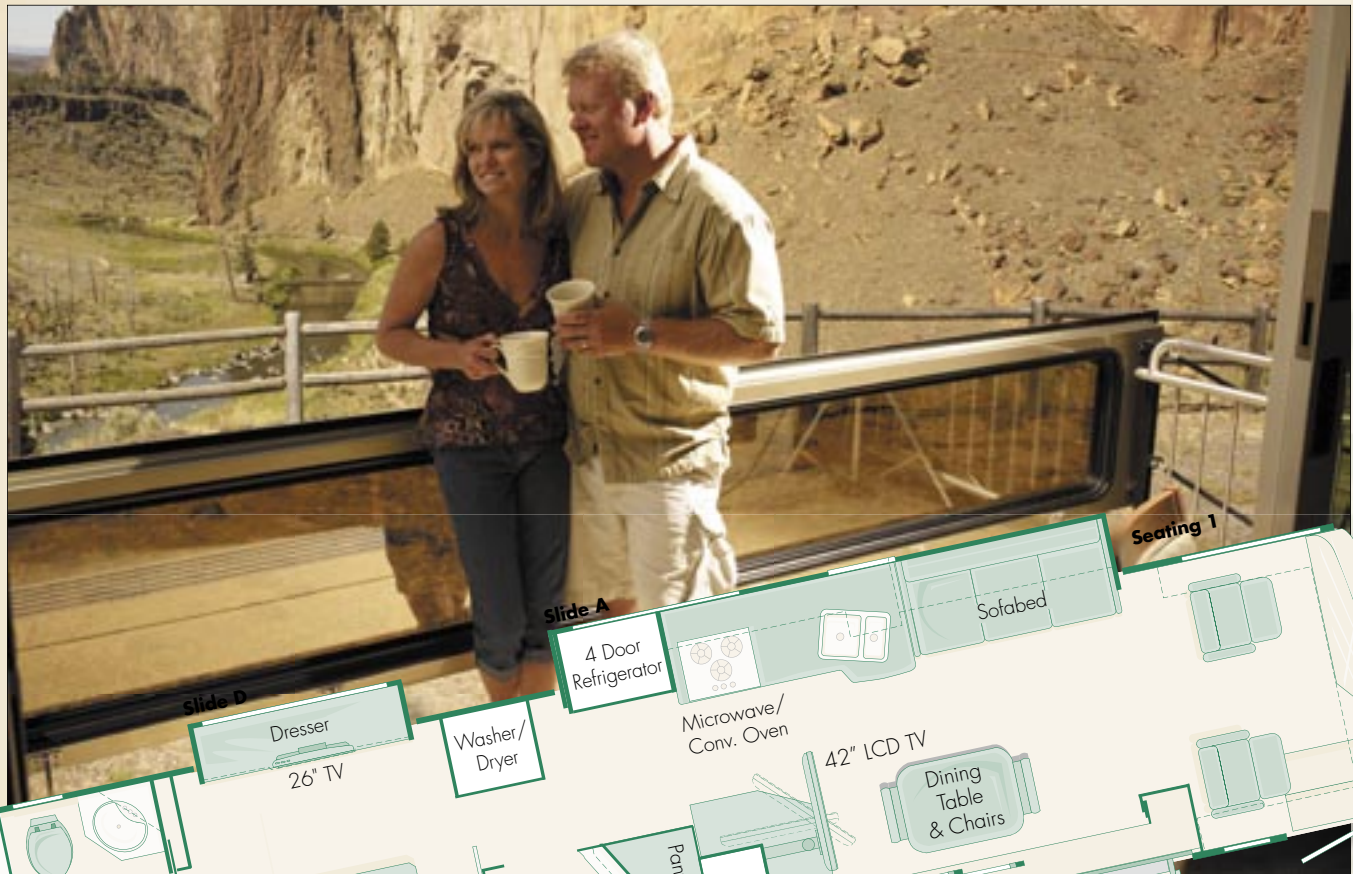

The Red Cloud Peak offers dual bathroom convenience paired with wide open Veranda living. Enjoy every scenic vista from you entire front living area, and step out of the Veranda deck for a closer look.

# Veranda 400 45' MOUNT RAINIER



Live large in the 45' Mt. Rainier. This beautiful floorplan offers Country Coach's largest available shower in one of two bathrooms, plus a large galley and a full size Veranda deck.



# Veranda 500 45' MT. MCKINLEY

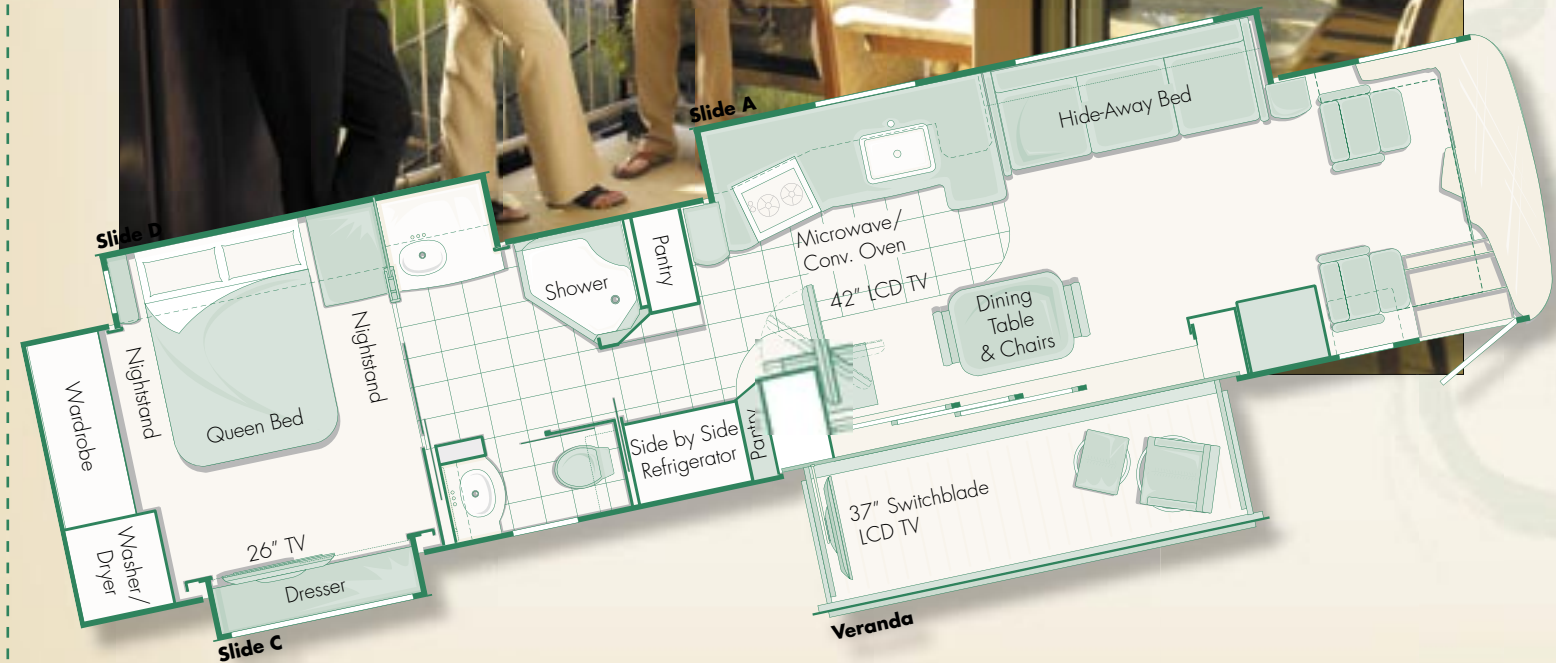

Live the suite life in the 45' Mt. McKinley. Each living area offers luxurious comfort, from the expansive bedroom/bathroom suite to the Veranda-enhanced living and dining area. Create a masterpiece in this chef's galley, and dine al fresco!

# Veranda 600 & 700 45' PIKES PEAK & 45' MT. WHITNEY

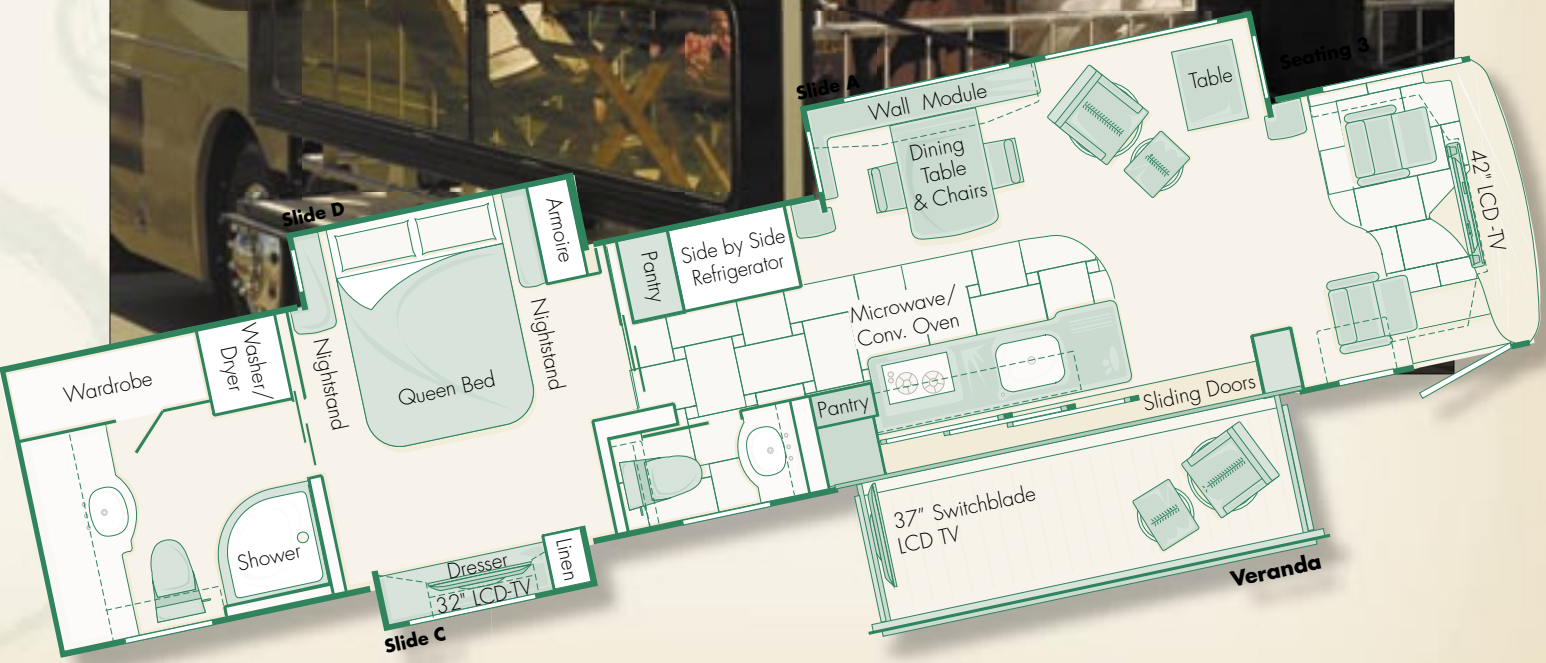

The Pike's Peak and Mt. Whitney are Country Coach's only galley Veranda floorplans creating a uniquely multifunctional and comfortable social space. Prepare meals from inside or from the Veranda deck.



## How it All Started

Born of an idea conceived by company president & CEO Jay Howard, the Veranda was developed in top secret conditions for 18 months before making its market debut in July, 2008.

The concept of inside-out living is rooted in Jay's experience in the desert of Indio, California, where he & Bob Lee developed a luxury motorcoach resort. There, at each space a small house was constructed with huge sliding glass walls that could be opened wide to unite the interior with the open patio. Borrowed from the world of fine custom homes, this design feature proved to be a resounding success with motorcoach owners.

Determined to bring this same lifestyle design into the world of luxury motorcoaches, Country Coach's R&D and Engineering teams took on the challenge to answer the many questions, and find a way to make the vision a reality.

The company's highly skilled group of engineers developed the project behind a canvas curtain in the company's secure

research-and-development building. Less than 20 people at Country Coach knew about the project throughout its first nine months of development. Behind that curtain, the system was built, tested, re-tested, re-built, proto-typed as a new motorcoach, and tested anew.

Today, this remarkable entirely new motorcoach is more than its team of creators could have dreamed it could be. The Veranda is a testament to Country Coach's renewed dedication to constant lifestyle enhancement through innovation.

So, as the inventors apply for patents, and customers discover a whole new way to enjoy their lifestyle, the Country Coach team is hard at work on more than 30 entirely new projects, set to debut over more than ten years. The Veranda is simply the first RV revolution launched from the behind R&D's canvas curtain. Customers are asking for lifestyle upgrades, and Country Coach is answering. There is so much more on the way.

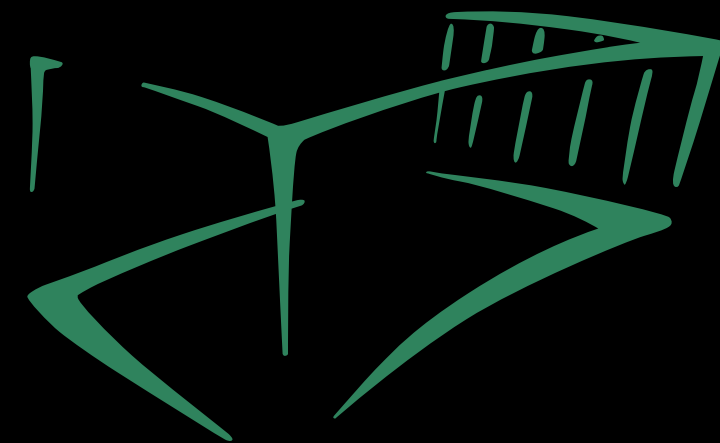





 **COUNTRY COACH**  
THE WORLD'S FINEST MOTORCOACHES

**1-800-654-0223**

[www.countrycoach.com](http://www.countrycoach.com)

PO Box 400 • Junction City, OR 97448