

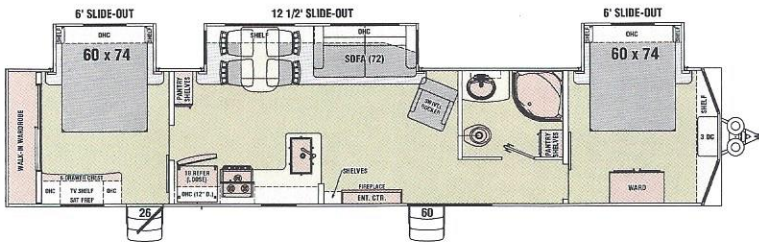

FLOOR PLANS

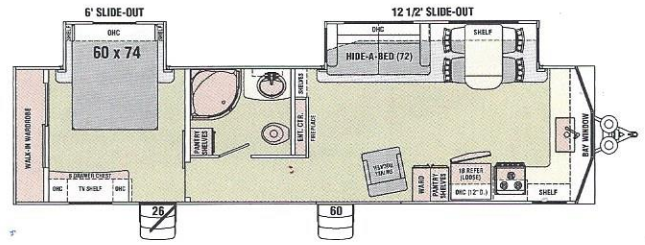

GB44DQ



GB35FK

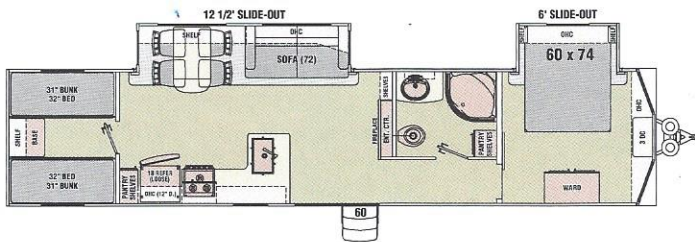

GB39BH

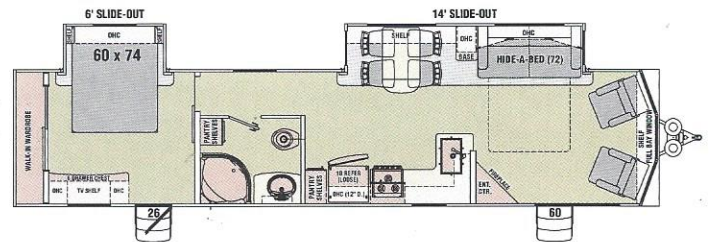

GB39MK

STANDARD FEATURES

Construction

- ◆ 2"x4" Floor Joists w/ T&G Plywood Decking
- ◆ 2"x2" Exterior Walls w/ R-7 Insulation
- ◆ Fiberglass Bay Front
- ◆ Bow Truss Rafters w/ 3/8" Wood Decking
- ◆ One Piece UV Resistant Roof Membrane

Exterior

- ◆ Detach Hitch
- ◆ Dual Pane Patio Door w/ Vertical Blinds
- ◆ 20' Manual Awning
- ◆ Triple Entry Steps

Interior

- ◆ Power Slide-Out Rooms
- ◆ Day / Night Soft Shade Blinds
- ◆ High Efficiency, LED Ceiling Lights
- ◆ Dining Room Table w/ 4 Chairs
- ◆ Hide-A-Bed Sofa
- ◆ Hand Crafted Window Treatments

Kitchen

- ◆ Solid Surface Counter Tops & Sink Covers
- ◆ Hardwood Cabinet Doors / Hidden Hinges
- ◆ 18 C.F. Refer & Furrion Stove Top Oven
- ◆ Microwave & Power Vent
- ◆ High Rise Residential Faucet

Bedroom

- ◆ Queen Size Mattress
- ◆ Under Bed Storage w/ Gas Struts
- ◆ Overhead Cabinet Above Bed
- ◆ Side Shelves Beside Bed
- ◆ Outlets & USB Jacks Beside Bed
- ◆ Abundant Closet & Drawer Storage

Bathroom

- ◆ One Piece Upgrade Fiberglass Shower
- ◆ Radius Glass Shower Doors
- ◆ Porcelain Foot Flush Toilet
- ◆ Skylight Over Shower
- ◆ Towel Bar & Paper Towel Holder

Plumbing

- ◆ (2) 30# LP Gas Bottles w/ Regulator
- ◆ 10 Gal. Gas/Elect., DSI Water Heater
- ◆ 40 Gal. Black & Grey Waist Water Tanks
- ◆ City Water Hook Up Connection
- ◆ Floor Ducted, 35K BTU Furnace

Electrical

- ◆ 50 Amp Elect. Hook-up w/ 25' Power Cord
- ◆ Contemporary LED Lighting Fixtures
- ◆ Ceiling Ducted 13.5K BTU A/C w/ Wall T-Stat
- ◆ Recessed Ceiling Fan