

ENTEGRA

COACH®



44779

Vision XL



Serial #: 1JSMABU0V1UC8093
 Model: 36C VISION XL MHA
 VIN#: 1F66F5DN9T0A01330
 Model Year: 2027 Dealer Name: MOTOR HOME SPECIALIST
 5411 SOUTH I-35 WEST
 ALVARADO, TX 76009
 USA

Standard Equipment

- Ford® F53 chassis
- GVWR - 22,000 lb. (36A, 34G), 30,000 lb. (36A, 36C)
- GCWR - 26,000 lb. (34B, 34G), 30,000 lb. (36A, 36C)
- 7.3L V-8 335 HP engine with 468 ft.-lb. torque
- 6-speed automatic TorqShift® transmission
- Catalytic converter theft deterrent
- 5,000 lb. rear hitch receiver with dual connector and 7-pin plug
- TuffShell™ vacuum-bond laminated roof, floor and sidewalls
- One-piece, seamless fiberglass front and rear cap
- One-piece, seamless, crowned fiberglass roof
- Tavel-view entry door
- Root ladder
- TV and FM Booster Antenna
- (2) 6V AGM (220Ah) house batteries on slideout tray
- LP quick-connect hookup
- Heated holding tanks (12V pads)
- Outside shower
- Centralized water filtration system
- Hydraulic leveling jacks
- Electric patio awning with LED lights
- 7,000W generator with auto-gen start
- 50-amp electrical service
- 50-amp electrical service
- E-Z Drive™: Computer-balanced driveshaft, variable-rate front and rear stabilizer bars, 22.5in heavy-duty front and rear stabilizer bars, Michelin® tires
- 15,000 BTU A/C unit with heat pump and second 13,500 BTU A/C unit
- JBL® Exterior speakers, with Smart TV and Bluetooth® receiver
- 1,200W inverter
- Tankless water heater
- Android Auto™
- Sony® infotainment center with Apple CarPlay® and Backup and side-view cameras
- Smart TV in living area
- JBL® Audio system
- 200W solar panel with dual controller
- Slideout awning(s)

OPTIONAL EQUIPMENT INSTALLED ON THIS VEHICLE BY MANUFACTURER

- STANDARD INTERIOR EQUIPMENT
- 120 in. panoramic windshield
- Power front privacy shade with manual side privacy shades
- Firefly Multiplex system
- Hardwood cabinet doors and drawer fronts
- 30,000 BTU auto-ignition ducted furnace (31UL,34B, 34G)
- (2) 30,000 BTU auto-ignition ducted furnaces (36A, 36C)
- Electric fireplace (34B, 34G, 36C)
- Legless dinette table
- 2-point lap safety belts in all designated seating locations
- Residential refrigerator
- TuffShell™ vacuum-bond laminated roof, floor and sidewalls
- All-in-one cooktop and oven
- Residential-size microwave
- USB port and wireless charging in nightstands
- Smart TV in bedroom
- Bunks with 300 lb. capacity each
- Smoke alarm
- Carbon monoxide detector
- Fire extinguisher
- (2) 6V AGM (220Ah) house batteries on slideout tray
- LP quick-connect hookup
- Heated holding tanks (12V pads)
- Outside shower
- Centralized water filtration system
- Hydraulic leveling jacks
- Electric patio awning with LED lights
- 7,000W generator with auto-gen start
- 50-amp electrical service
- E-Z Drive™: Computer-balanced driveshaft, variable-rate front and rear stabilizer bars, 22.5in heavy-duty front and rear stabilizer bars, Michelin® tires
- 15,000 BTU A/C unit with heat pump and second 13,500 BTU A/C unit
- JBL® Exterior speakers, with Smart TV and Bluetooth® receiver
- 1,200W inverter
- Tankless water heater
- Android Auto™
- Sony® infotainment center with Apple CarPlay® and Backup and side-view cameras
- Smart TV in living area
- JBL® Audio system
- 200W solar panel with dual controller
- Slideout awning(s)

Base price	248,018.00
COASTAL DECOR	593.00
TEXAS PAINT	17,993.00
USA STANDARDS	n/c
CUSTOMER VALUE PACKAGE	11,250.00
RESIDENTIAL REFRIGERATOR	n/c
NO WASHER/DRYER	n/c
SOFA - TRADITIONAL	n/c
FRONT OVERHEAD BUNK	3,293.00
UNIT TOTAL	281,147.00
DEALER INSTALLED OPTIONS	

Manufacturer's Suggested Retail Price

\$281,147.00

TOTAL AMOUNT DOES NOT INCLUDE STATE AND LOCAL TAXES OR LICENSE FEES. THE PRICE SHOWN ABOVE MAY OR MAY NOT BE REPRESENTATIVE OF THE ACTUAL SELLING PRICE OF SIMILAR RECREATIONAL VEHICLES IN YOUR AREA.

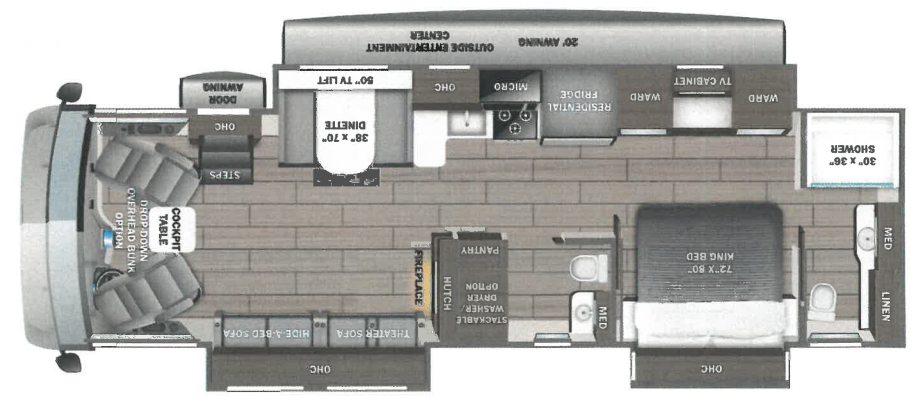

DIMENSIONS

Exterior height:.....154.00" Fresh water tank (gals.):...72.00
 Exterior width:.....101.00" Gray water tank (gals.):...72.00
 Black water/toilet tank (gals):.....72.00
 Propane (lbs.):.....56
 Propane (gals.):.....13
 Water heater (gals.):.....0.00

TIRES

Tire size (front):.....255/80R22.5G
 Tire size (mid):.....
 Tire size (rear):.....255/80R22.5G

Some dimensions may be rounded and may vary from the actual dimensions
 Weights may be estimated calculations and may vary from the actual weight
 - refer to the vehicle weight labels for actual weights***
 Floorplans, features and specifications are subject to change without notice.

