



Emblem



Serial #: 1JSMEABU7M1DU8067
Model: 36U EMBLEM MHA
VIN#: 1F66F5DN0L0A10644
Model Year: 2021 Dealer Name: MOTOR HOME SPECIALIST
5411 SOUTH I-35 WEST
ALVARADO, TX 76009
USA

Manufacturer’s Suggested Retail Price \$200,506.00

TOTAL AMOUNT DOES NOT INCLUDE STATE AND LOCAL TAXES OR LICENSE FEES. THE PRICE SHOWN ABOVE MAY OR MAY NOT BE REPRESENTATIVE OF THE ACTUAL SELLING PRICE OF SIMILAR RECREATIONAL VEHICLES IN YOUR AREA.

Standard Equipment

Optional Equipment

THE FOLLOWING ITEMS ARE STANDARD ON THIS MODEL AT NO EXTRA CHARGE

OPTIONAL EQUIPMENT INSTALLED ON THIS VEHICLE BY MANUFACTURER

- Exterior
- Ford® F53 chassis
 - 7.3L V-8 350 HP engine with 468 ft.-lb. torque
 - 6-speed automatic TorqShift® transmission with overdrive and tow haul mode
 - 210-amp alternator
 - G-rated highway tires- 255/80R22.5
 - Front and rear disc, 4-wheel anti-lock brakes
 - 5,000 lb. rear hitch receiver with dual connector and 7-pin plug
 - 12V chassis battery
 - 80 gal. fuel tank
 - 120 in. panoramic windshield
 - TuffShell™ vacuum-bond laminated roof, floor and sidewalls
 - Bead-foam insulation (R-24 max roof, R-9 max floor, R-8 max walls)
 - One-piece, seamless, crowned fiberglass roof
 - Premium Sikkens full body paint
 - Third brake light
 - Entrance door with industry’s largest travel view window
 - One-piece, seamless, fiberglass front and rear caps
 - Electric-powered entrance step
 - Lockable pass-through storage compartments with slam latches
 - (2) 6V AGM (220Ah) house batteries on slideout tray
 - 12V demand water pump
 - Thetford® Sani-Con Turbo Macerator system
 - 24.5 gal. propane tank (83 lb.)
 - LP quick-connect hookup
 - Exterior utility center
 - Winterization drain system
 - Outside shower
 - Black tank flush
 - Solar Prep
 - Porch light
 - Roof ladder

- Interior
- 6-way power and swivel driver and passenger seats
 - Soft-touch, vinyl wrapped automotive dash
 - A/C and cruise control
 - Tilt steering wheel
 - Auxiliary start
 - Firefly Multiplex system
 - 84 in. interior ceiling height with padded vinyl ceiling
 - Hardwood cabinet doors and drawers
 - Power front privacy shade with manual side privacy shades
 - High-intensity, recessed LED ceiling lights
 - Ball-bearing drawer guides
 - Furrion® stainless, recessed, gas cooktop with cast iron grill
 - Convection microwave oven
 - Powered roof vent in kitchen with wall switch
 - Furrion® electric fireplace
 - 21 cu.ft. residential refrigerator with ice and water in door
 - LED lit hardwood fascia
 - LED lit stainless steel bathroom sink
 - Water filtration system
 - Entegra-exclusive easy operation legless dinette table
 - 2-point lap safety belts in all designated seating locations
 - Blu-Ray™ player in living area
 - 35,000 BTU auto-ignition ducted furnace
 - Prep for satellite dish
 - Cable TV hookup with RG-6 coax and video selector switch
 - Digital antenna with signal booster
 - One-piece, fiberglass shower with glass door, skylight and light
 - Porcelain toilet with foot flush
 - Powered roof vent in bathroom with wall switch
 - Walk-around King-sized bed with bedspread and nightstands
 - Under-bed storage (select models)
 - Large wardrobes
 - LED TV in bedroom
 - Bunks with industry-exclusive 300 lb. capacity each (36T)
 - Decorative kitchen backsplash
 - Smoke alarm
 - Carbon monoxide detector

- Customer Value Package
- EZDRIVE™ ELITE: Computer-balanced driveshaft, Jounce bumpers, heavy-duty front and rear stabilizer bars, SACHS shocks
 - Automatic hydraulic leveling jacks
 - 15,000 BTU A/C unit with heat pump and second 13,500 BTU A/C unit
 - Pioneer® 8" infotainment center with Apple CarPlay® and Android Auto™
 - Backup and sideview cameras
 - Frameless windows
 - Electric patio awning with LED lights
 - Slideout cover awnings
 - Exterior entertainment center with outside speakers, LED TV mounted on swivel bracket and single-disc DVD/FM radio
 - Onan® Marquis Gold GenSet 5,500-watt generator with auto-gen start
 - 2,000-watt inverter
 - 50-amp electrical service
 - LED lit solid surface kitchen countertops with recessed stainless steel sink and covers
 - LED living room TV
 - Day/night roller shades
 - Removable driver/passenger cockpit table

Base price	183,750.00
Crossville	n/c
Black Walnut Paint	n/c
USA Standards	n/c
Customer Value Package	11,250.00
Residential Refrigerator	n/c
Cooktop with Oven	713.00
Washer/Dryer Combo	1,800.00
Booth Dinette	n/c
Sofa	n/c
Front Bunk Overhead	2,993.00

UNIT TOTAL 200,506.00

DEALER INSTALLED OPTIONS

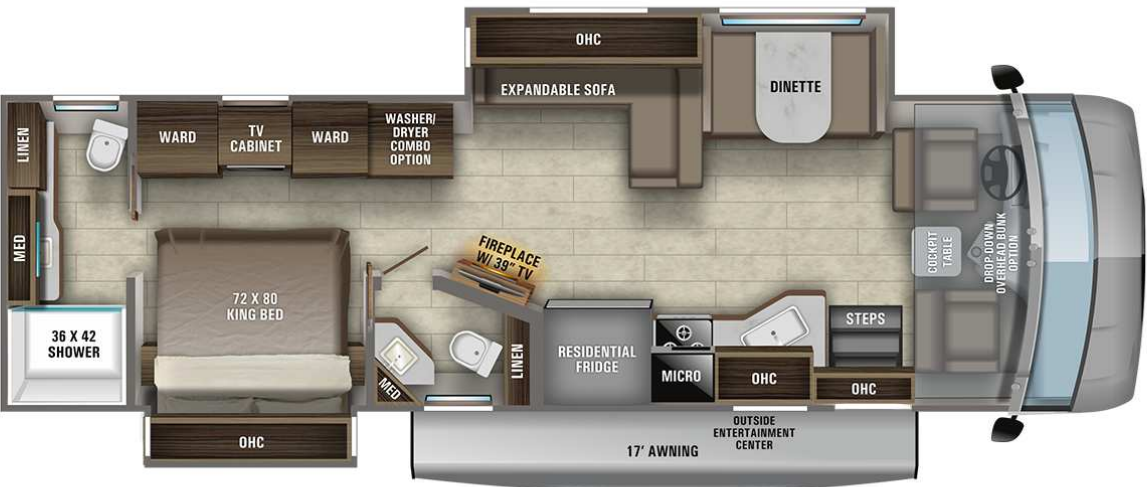

DIMENSIONS

Exterior height:.....154.00"
Exterior width:.....101.00"

CAPACITIES

Fresh water tank (gals.):...72.00
Gray water tank (gals.):...50.00
Black water/toilet tank (gals.):.....72.00
Propane (lbs.):.....83
Propane (gals.):.....19
Water heater (gals.):.....10.00

TIRES

Tire size (front):.....255/80R22.5G
Tire size (mid):.....
Tire size (rear):.....255/80R22.5G

Some dimensions may be rounded and may vary from the acutal dimensions
***Weights may be estimated calculations and may vary from the actual weight
- refer to the vehicle weight labels for actual weights***
Floorplans, features and specifications are subject to change without notice.