



**ENTEGR A**  
COACH®

# Accolade



Serial #: 1JSNECBU2N1HK8158  
 Model: 37K ACCOLADE MHC  
 VIN#: 4UZADVFC4NCNS9394  
 Model Year: 2022 Dealer Name: MOTOR HOME SPECIALIST  
 5411 SOUTH I-35 WEST  
 ALVARADO, TX 76009  
 USA

**Manufacturer's Suggested Retail Price \$322,464.00**

TOTAL AMOUNT DOES NOT INCLUDE STATE AND LOCAL TAXES OR LICENSE FEES. THE PRICE SHOWN ABOVE MAY OR MAY NOT BE REPRESENTATIVE OF THE ACTUAL SELLING PRICE OF SIMILAR RECREATIONAL VEHICLES IN YOUR AREA.

## Standard Equipment

THE FOLLOWING ITEMS ARE STANDARD ON THIS MODEL AT NO EXTRA CHARGE

- EXTERIOR**
- Freightliner® S2RV chassis
  - GVWR - 31,000 lb.
  - GCWR - 43,000 lb.
  - Cummins® ISB 6.7L 360 HP diesel engine with 800 ft.-lb. torque
  - Allison® 3000 MH automatic transmission
  - 185-amp alternator
  - G-rated highway tires - 275/80R22.5
  - Engine exhaust brake
  - 12,000-lb. hitch with 1,200-lb. tongue capacity and 7-pin plug
  - Dual 12V chassis batteries
  - 100-gal. fuel tank
  - 10-gal. DEF tank
  - Onan® 8,000-watt Quiet Diesel generator and auto-gen start (unless "prep only" noted in optional equipment)
  - Transfer switch with reverse polarity protection
  - (4) 6V AGM (220Ah) house batteries on slideout tray
  - 190W solar panel with dual controller
  - 35,000-BTU auto-ignition furnace
  - Furrion® electric fireplace (N/A 37TS)
  - 24.5-gal. propane tank (83 lb.)
  - LP quick-connect hookup
  - Thetford® Sani-Con Turbo Macerator system
  - Exterior utility center
  - Winterization drain system
  - Black tank flush
  - Outside shower
  - 12V demand water pump
  - Water filtration system
  - TuffShell™ vacuum-bond laminated roof, floor and sidewalls
  - Bead-foam insulation (R-24 max roof, R-9 max floor, R-5 max walls)
  - One-piece, seamless, crowned fiberglass roof
  - Premium Sikkens full-body paint
  - Automatic hydraulic leveling jacks
  - Alcoa® aluminum rims
  - Exterior entertainment center with outside speakers, LED TV mounted on swivel bracket and single-disc DVD/CD/AM/FM radio
  - Winegard® In-motion satellite dish
  - Deluxe heated, remote-controlled, side-view mirrors
  - Entrance door with industry's largest travel-view window
  - Electric-powered entrance steps
  - Slideout cover awnings
  - Carpeted, full pass-through storage compartments with lockable slam latch doors
  - Roof ladder
  - Smoke alarm
  - Carbon monoxide detector

- INTERIOR**
- 6-way power driver and passenger seats
  - Power windows and door locks
  - A/C and cruise control
  - Tilt steering wheel
  - Auxiliary start switch
  - Privacy curtains for cab area
  - Custom-molded ABS surround in cab-over area
  - Overhead bunk with 750 lb. capacity
  - Firefly Multiplex system
  - High-intensity recessed LED ceiling lights
  - 84-in. interior ceiling height with padded vinyl ceiling
  - Raised-panel hardwood cabinetry throughout
  - Deluxe hidden cabinet hinges
  - Ball-bearing drawer guides
  - Vinyl plank flooring
  - Entegra-exclusive, easy-operation legless dinette table
  - LED HD Smart Fire TV in living area
  - Cable TV hookup with RG-6 coax and video selector switch
  - Winegard 2.0 Wifi/4G antenna
  - Wood-framed kitchen window with spice cabinets
  - 2-burner induction cooktop
  - LED-lit, solid-surface kitchen countertops with recessed stainlesssteel sink and sink covers
  - Flip-up countertop extension (select models)
  - One-piece, fiberglass shower with glass door, skylight and light
  - Porcelain toilet with foot flush
  - Recessed, LED-lit, stainless steel bathroom sink
  - Powered roof vent in bathroom with wall switch
  - Walk-around, King-size bed with bedspread and nightstands
  - Under-bed storage (select models)
  - LED TV in bedroom
  - Large wardrobes
  - Bunks with industry-exclusive, 300-lb. capacity each (37L)
  - 2-point lap safety belts in all designated seating locations
  - Third brake light
- CUSTOMER VALUE PACKAGE**
- E-Z DRIVE™ PREMIER: Computer-balanced driveshaft, rear air suspension, heavy-duty rear stabilizer bar, full air brakes, SACHS shocks
  - One-piece, seamless, fiberglass front and rear caps
  - Automotive-bonded panoramic window in front cap with power shade
  - Dual-pane, tinted, safety-glass windows
  - (2) 15,000 BTU A/C units with heat pumps
  - Electric patio awning with LED lights
  - 2,000-watt pure sine wave inverter
  - Power cord reel with 50-amp service
  - Girard® tankless water heater
  - Sony® infotainment center with Apple CarPlay® and Android Auto™
  - Backup and side-view cameras
  - Residential refrigerator
  - Residential-size convection microwave

## Optional Equipment

OPTIONAL EQUIPMENT INSTALLED ON THIS VEHICLE BY MANUFACTURER

Base price	312,443.00
Richmond	n/c
Cobblestone Full Paint	30.00
USA Standards	n/c
22 FR S2RV 31000 279"	
360 NA15	n/c
Customer Value Package	6,750.00
Residential Refrigerator	n/c
Washer/Dryer Stack	2,048.00
IN Motion DISH Satellite System	n/c
Slideout Tray w/Electric Cooler in Basement	1,193.00
Booth Dinette	n/c

UNIT TOTAL **322,464.00**

DEALER INSTALLED OPTIONS

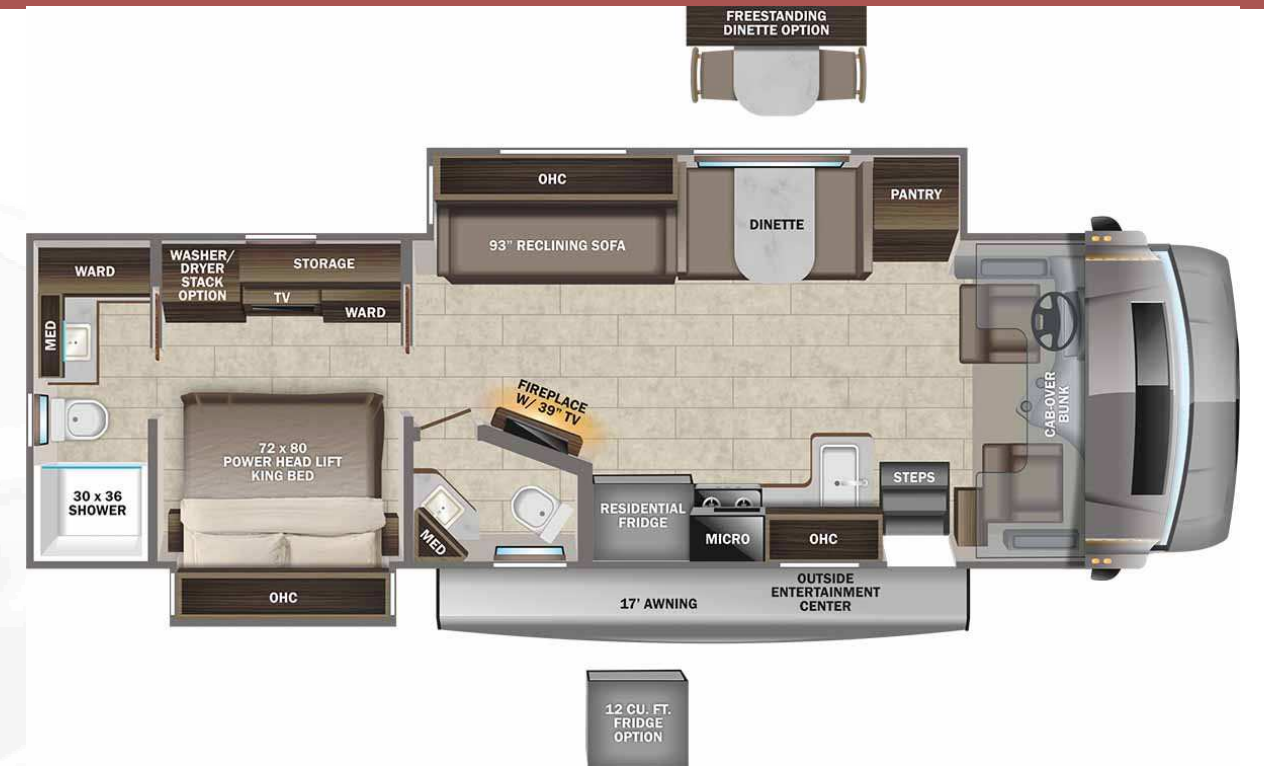

### DIMENSIONS

Exterior height:.....160.00"  
 Exterior width:.....101.00"

### CAPACITIES

Fresh water tank (gals.):...72.00  
 Gray water tank (gals.):...91.00  
 Black water/toilet tank (gals.):.....63.00  
 Propane (lbs.):.....83  
 Propane (gals.):.....19  
 Water heater (gals.):.....0.00

### TIRES

Tire size (front):.....275/80R22.5G  
 Tire size (mid):.....  
 Tire size (rear):.....275/80R22.5G

\*\*\*Some dimensions may be rounded and may vary from the actual dimensions\*\*\*

\*\*\*Weights may be estimated calculations and may vary from the actual weight

- refer to the vehicle weight labels for actual weights\*\*\*

Floorplans, features and specifications are subject to change without notice.