



Qwest



Serial #: 1JSLECBLXM1ZL8100
Model: 24L QWEST MHC
VIN#: W1X8E33Y9LN108213
Model Year: 2021 Dealer Name: MOTOR HOME SPECIALIST
5411 SOUTH I-35 WEST
ALVARADO, TX 76009
USA

Standard Equipment

Optional Equipment

THE FOLLOWING ITEMS ARE STANDARD ON THIS MODEL AT NO EXTRA CHARGE

OPTIONAL EQUIPMENT INSTALLED ON THIS VEHICLE BY MANUFACTURER

- Exterior

 - Mercedes-Benz® 3500 chassis with 170 in. wheelbase
 - V-6 Turbo 188 HP diesel engine with electronic fuel injection and 325 ft.-lb. torque
 - 7-speed automatic transmission
 - 220-amp alternator
 - E-rated highway tires- 215/85R16
 - Front and rear disc, 4-wheel anti-lock brakes
 - 5,000 lb. rear hitch receiver with dual connector and 7-pin plug
 - 12V chassis battery
 - 24.5 gal. fuel tank
 - 5.8 gal. DEF tank
 - Premium Sikkens full body paint
 - TuffShell™ vacuum-bond laminated roof, floor and sidewalls
 - Bead-foam insulation (R-24 max roof, R-9 max floor, R-5 max walls)
 - One-piece, seamless, fiberglass roof
 - Partial fiberglass rear cap
 - Chrome grill package
 - Entrance door with industry's largest travel view window
 - Slideout cover awnings
 - Electric-powered entrance step with integrated house battery compartment
 - Third brake light
 - Aluminum skirt-hung baggage doors
 - 1,000-watt inverter
 - 30-amp electrical service
 - Onan® 3,600-watt LP generator
 - (2) 12V house batteries
 - 12.2 gal. propane tank (41 lb.)
 - Exterior utility center
 - Winterization drain system
 - Black tank flush
 - Outside shower
 - LP quick-connect hookup
 - Aluminum rims
 - Solar prep
 - Porch light
- Interior

 - 10.25 in. integrated Mercedes-Benz® infotainment center with GPS
 - Power windows and door locks
 - A/C and cruise control
 - Tilt steering wheel
 - Auxiliary start switch
 - Cab area privacy curtain
 - Driver and passenger air bags
 - Custom molded ABS surround in cab-over area
 - 80 in. interior ceiling height with padded vinyl ceiling
 - Ball-bearing drawer guides
 - Tecnoform® high-gloss cabinetry and countertops
 - High-gloss hardwood fascia
 - 6 cu. ft. gas/electric/12 volt refrigerator
 - Suburban 2-burner, drop-in cooktop with flush cover
 - Stainless convection microwave
 - Stainless steel sink with wooden cover/cutting board
 - Decorative kitchen backsplash
 - 12V demand water pump
 - Digital antenna with signal booster
 - 15,000 BTU low-profile A/C
 - 20,000 BTU auto-ignition ducted furnace
 - Water filtration system
 - 12V USB charging station in dinette area
 - Entegra-exclusive easy operation legless dinette table (24K, 24R)
 - U-shaped dinette with stow away pedestal legs (24L)
 - 2-point lap safety belts in all designated seating locations
 - High-intensity LED ceiling lights
 - Day/night roller shades
 - Powered roof vent in living area with wall switch
 - LED living room TV
 - Blu-Ray™ player in living area
 - Cable TV hookup with RG-6 coax
 - Prep for satellite dish
 - Porcelain toilet with foot flush
 - Shower with decorative surround and skylight
 - Stainless steel bathroom sink
 - Powered roof vent in bathroom with wall switch
 - Queen-sized bed with bedspread (24K, 24L)
 - Queen-sized power Murphy bed (24R)
 - (2) Twin-sized beds (24T)
 - Under-bed storage (select models)
 - Large wardrobes
 - Bedroom TV prep
 - Overhead bunk with 750 lb. capacity
 - Smoke alarm
 - Carbon monoxide detector
- Customer Value Package

 - One-piece, seamless, fiberglass front cap
 - Automotive-bonded, panoramic window in front cap with power shade
 - Electric stabilizer jacks
 - Rear backup camera
 - Heated holding tanks (12V pads)
 - Frameless windows
 - Girard® armless patio awning with LED light strip
 - Truma AquaGo Comfort Plus tankless water heater
 - Ultraleather® swivel driver and passenger seats with boosters
 - Remote keyless entry

Base price	154,343.00
Solstice	n/c
Serenity Full Body Paint	n/c
USA Standards	n/c
Customer Value Package	7,050.00
3.2 KW Diesel Generator	5,243.00
Hydraulic Auto Leveling	
Jacks	3,893.00
Standard House Battery	n/c
Sun Folding Windshield	
Shade	428.00
Dinette	n/c
Front Cap Cab-Over	n/c

UNIT TOTAL	170,957.00
DEALER INSTALLED OPTIONS	

Manufacturer's Suggested Retail Price \$170,957.00

TOTAL AMOUNT DOES NOT INCLUDE STATE AND LOCAL TAXES OR LICENSE FEES. THE PRICE SHOWN ABOVE MAY OR MAY NOT BE REPRESENTATIVE OF THE ACTUAL SELLING PRICE OF SIMILAR RECREATIONAL VEHICLES IN YOUR AREA.

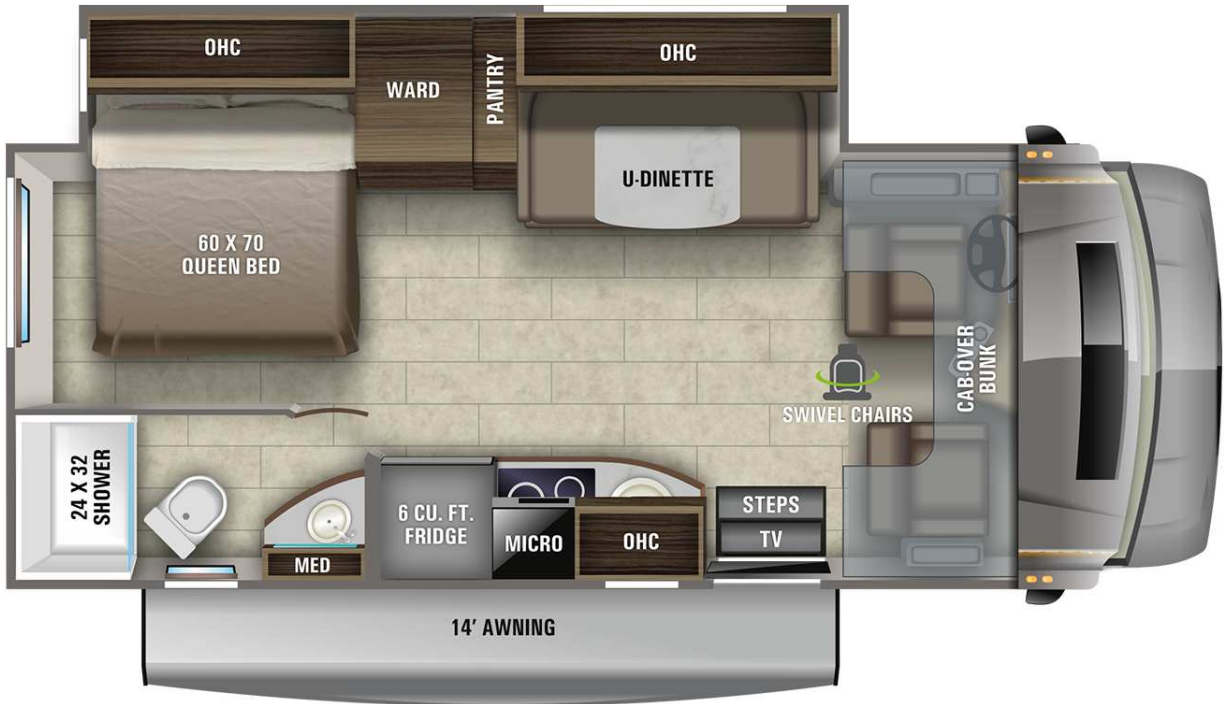

DIMENSIONS

Exterior height:.....131.00"
Exterior width:.....96.00"

CAPACITIES

Fresh water tank (gals.):...43.00
Gray water tank (gals.):...31.00
Black water/toilet tank (gals.):.....31.00
Propane (lbs.):.....41
Propane (gals.):.....9
Water heater (gals.):.....6.00

TIRES

Tire size (front):.....LT215/85R16
Tire size (mid):.....
Tire size (rear):.....LT215/85R16

Some dimensions may be rounded and may vary from the acutal dimensions
***Weights may be estimated calculations and may vary from the actual weight
- refer to the vehicle weight labels for actual weights***
Floorplans, features and specifications are subject to change without notice.