



ENTEGRA  
COACH®

Aspire



Serial #: 1JSMEACV0M13W8066  
Model: 44W ASPIRE MHA  
VIN#: 4VZAU1D92MC089595  
Model Year: 2021 Dealer Name: MOTOR HOME SPECIALIST  
5411 SOUTH I-35 WEST  
ALVARADO, TX 76009  
USA

Manufacturer’s Suggested Retail Price \$494,941.00

TOTAL AMOUNT DOES NOT INCLUDE STATE AND LOCAL TAXES OR LICENSE FEES. THE PRICE SHOWN ABOVE MAY OR MAY NOT BE REPRESENTATIVE OF THE ACTUAL SELLING PRICE OF SIMILAR RECREATIONAL VEHICLES IN YOUR AREA.

Standard Equipment

THE FOLLOWING ITEMS ARE STANDARD ON THIS MODEL  
AT NO EXTRA CHARGE

- Exterior
- Spartan® K2 raised-rail chassis
  - Cummins® L9 turbocharged 450 HP engine 1,250 lb. ft. torque at 1,400 RPM
  - Allison® 3,000 MH 6-speed transmission
  - Side-mounted radiator
  - Equalizer hydraulic automatic coach leveling
  - Sidewalls- 2-1/2" exterior walls with Alumina-Tru™ welded tubular aluminum studs on 16" centers or less filled with bat and Flexfoil insulation then covered with high-gloss gelcoat fiberglass (R-16)
  - Floors- 2" x 4" wood trusses on 16" centers or less filled with bat and Flexfoil insulation then topped with 3/4" 7-ply plywood decking (R-33)
  - X-Bridge™ bracing welded into chassis frame
  - Steel-reinforced front cap and windshield frame
  - Insulated front and rear caps (R-24)
  - Roof- 4" arched aluminum trusses filled with bat insulation and reflective Flexfoil® topped with 3/8" plywood decking then one-piece fiberglass
  - Entegra-exclusive Relia-Torque flush-mounted 12V slideout system with VegaTouch and push button controls
  - Aqua-Hot® heated basement storage on thermostat
  - (3) 15,000 BTU A/C units with heat pumps and condensation drain system
  - (2) L16 AGM batteries (6V/390 amp hrs. ea.)
  - Black holding tank sprayer
  - Sani-Con® Macerator holding tank dump system with manual gate valves and manual backup
  - 50 amp power cord on electric powered reel
  - Onan® 10,000 watt diesel generator, with automatic start, on slide-out tray
  - Aqua-Hot® 400D hydronic water and heating system with in-floor heat throughout
  - 3,000 watt pure sine wave inverter
  - Premium surge protector with smart transfer switch
  - Water hose with electric reel
  - City and tank water filtration system
  - Trutank™ ultrasonic tank monitoring system displayed on VegaTouch screen
  - Winterizing drain system
  - Manual slideout storage tray
  - Daytime running lights
  - Girard® power entrance door awning with LED lights
  - Dual roof-mounted Girard® Vision dual pitched patio awnings with LED lights
  - Girard® window awnings
  - Power rear engine door with manual override
  - Diamond Shield™ front protective film mask
  - 43" Samsung® 4K UHD Smart TV with JBL Bar Studio sound bar on TV bracket with extend, tilt and swivel arm
  - LED low beam headlights, Halogen high beam headlights and fog lights
  - Lit grab handle with keypad system for keyless entry
  - LED marker lights, third brake light, turn lights, license plate light, accent lights, & docking lights
  - Chrome, heated, remote control, side-view mirrors with integrated cameras
  - Full-width rear mudflap, with chrome ""Aspire"" nameplate
  - Winegard® TRAV'LER satellite dish DIRECTV®-standard with USA option
  - Winegard® WIFI extender with 4G/LTE
  - Heated exterior utility center with 5" LED Firefly® tank monitoring panel
  - Winegard® Rayzar Z1 TV antenna
  - Frameless, dual-pane, tinted safety-glass windows
  - Girard® slideout awnings
  - LED accent lights under passenger slideout rooms

- Interior
- (2) dual USB ports and (2) 12V socket for charging
  - Xite™ 360° camera system that displays on digital dash screen
  - Valid 12.3" digital dash with quad core graphics processor with ability to display on-board diagnostics, traditional instrument cluster, 360 degree camera system or Rand McNally™ GPS navigation.
  - 6-way power, lumbar, Ultra-Leather driver and passenger seats with integrated seatbelt
  - Powered flush stepwell cover
  - Xite™ XSG3 infotainment system with navigation, Bluetooth, Sirius XM and AM/FM tuner
  - Power adjustable brake and accelerator pedals
  - Tire pressure monitoring system (TPMS) with temperature monitoring
  - Push button start system
  - VIP, power tilt and telescoping steering wheel with integrated controls for cruise, wipers radio controls and Bluetooth phone functionality
  - JBL® premium 5-speaker audio sound system with speakers, amplifier and DVC sub-woofer
  - Powered front sun visors and privacy shade
  - Ultra-Vision® one-piece wrap-around tinted windshield
  - Bar area with beverage chiller and rain glass upper cabinet door with LED accent lighting (44R only)
  - Central vacuum system
  - 10" VegaTouch touchpad system for complete integration of coach controls (mobile app available)
  - Sony® HD Blu-Ray™ player
  - Hand-laid, high-gloss porcelain floor tiles
  - Premium Villa UltraLeather® furniture
  - Aire-Secure™ travel locks for all pocket doors
  - Premium recessed LED 12V lighting
  - Manual solar day and blackout night shades
  - 50" Samsung® 4K UHD Smart TV
  - 32" Samsung® LED 1080P Smart TV in front overhead
  - Samsung® sound bar with sub-woofer
  - Whirlpool® stacked washer and dryer
  - Induction cooktop with matching wood cover
  - 24" stainless EZ clean Fisher and Paykel dishwasher
  - Solid surface countertops with stainless steel sink and dimmable LED accent lighting
  - Whirlpool® 1.9 cu. ft. convection microwave oven
  - Whirlpool® stainless steel residential refrigerator with ice maker and water dispenser
  - Maxxair® power vent exhaust fan with intake and touch screen control
  - Large deep drawer for waste basket with easy access trash chute (trash chute not available on 40P and 44R)
  - King-sized gel memory-foam mattress
  - Ceiling fan in bedroom
  - Sony® Blu-Ray™ player
  - Nightstands with USB ports and solid surface tops
  - JBL® Studio sound bar in bedroom
  - 32" Samsung® LED Slim 1080P Smart TV in bedroom
  - Solid surface countertops with integrated sink and dimmable LED accent lighting
  - Textured porcelain tile shower with skylight and clear glass shower door
  - Fixed shower head and separate hand held spray wand
  - Teakwood shower seat (Not available in 44F)
  - SaniFlo macerator toilet in main bath(N/A 42DEQ and 44Z)
  - Porch light and motion sensor security lights
  - Security system with glass shatter sensors
  - Window with slider and screen
  - Removable screen on entry door
  - Aqua View Showermiser water saving system

Optional Equipment

OPTIONAL EQUIPMENT INSTALLED ON THIS VEHICLE  
BY MANUFACTURER

|                            |            |
|----------------------------|------------|
| Base price                 | 484,530.00 |
| SMOKE DETECTOR - MDM139.36 | n/c        |
| Cobblestone                | n/c        |
| Paint Iris                 | n/c        |
| USA Standards              | n/c        |
| 21 SP 49000 320" 450 TAG   |            |
| AXLE 2017 EMISSIONS MXM    | n/c        |
| Stonewall Gray Cabinetry   | 4,493.00   |
| White Accent Bathroom      |            |
| Wood                       | n/c        |
| Dishwasher Drawer          | n/c        |
| Winegard Trav'ler          |            |
| Satellite Antena W/DISH    |            |
| Network                    | n/c        |
| Dual Solar Panels          | 2,775.00   |
| Four Batteries             | 1,643.00   |
| Booth Dinette              | 375.00     |
| Theater Seating Sofa       | 1,125.00   |
| Sofa with TV Lift          | n/c        |
| Sleepmade Gel Memory       |            |
| Mattress                   | n/c        |
| SIS Ins DK Toreador        |            |
| Stripe ILO Blue            | n/c        |

UNIT TOTAL 494,941.00

DEALER INSTALLED OPTIONS

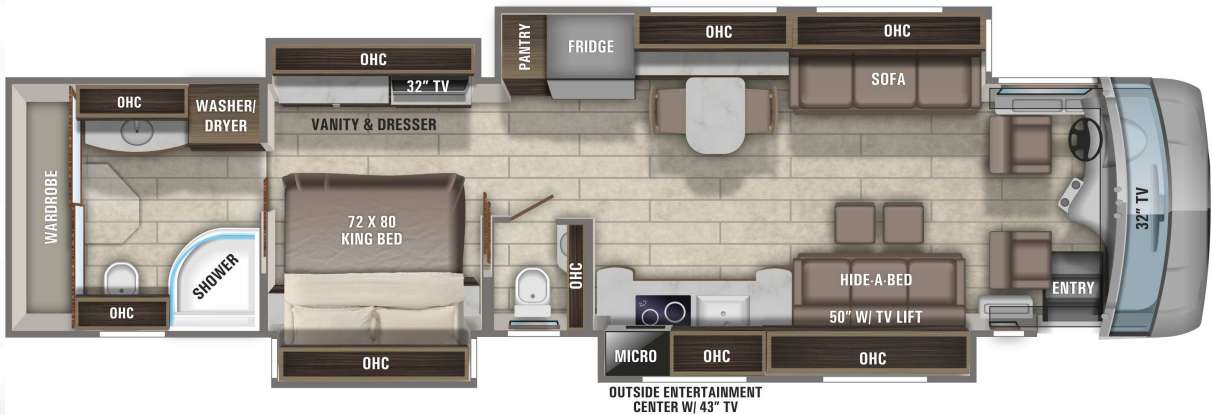

DIMENSIONS

Exterior height:.....152.00"

Exterior width:.....101.00"

CAPACITIES

Fresh water tank (gals.):..100.00

Gray water tank (gals.):....62.00

Black water/toilet tank (gals.):.....41.00

Propane (lbs.):.....0

Propane (gals.):.....0

Water heater (gals.):.....0.00

TIRES

Tire size (front):.....315/80R22.5

Tire size (mid):.....295/80R22.5

Tire size (rear):.....295/80R22.5

\*\*\*Some dimensions may be rounded and may vary from the acutal dimensions\*\*\*

\*\*\*Weights may be estimated calculations and may vary from the actual weight

- refer to the vehicle weight labels for actual weights\*\*\*

Floorplans, features and specifications are subject to change without notice.